

Dimensions

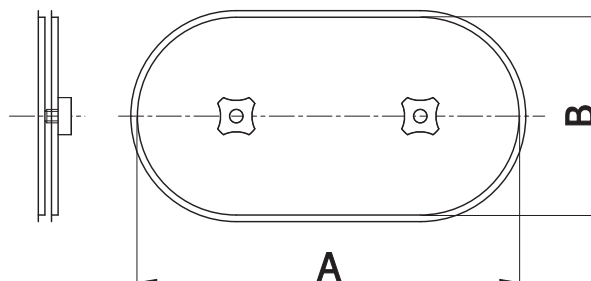

Description

IPFQ access doors is the easiest, most reliable and convenient way for creating inspections hatches in rectangular ventilation ducts. IPFQ structure, together with adhesive gasket, makes an ideal alignment with a duct surface. Two piece construction, tighten together with knobs, closes tightly around the inspection opening and provides a D class air tightness for ventilation systems.

Available materials:
IPR-...- galvanized steel

Example identification

Product code: IPFQ - aaa

type _____
AxB _____

code	A [mm]	B [mm]
IPFQ-180-80	180	80
IPFQ-200-100	200	100
IPFQ-300-150	300	150
IPFQ-300-200	300	200
IPFQ-400-200	400	200
IPFQ-400-300	400	300
IPFQ-500-300	500	300
IPFQ-500-400	500	400
IPFQ-600-400	600	400
IPFQ-600-500	600	500
IPFQ-700-500	700	500

* A and B - dimensions of the hole to be cut in the duct

Technical data

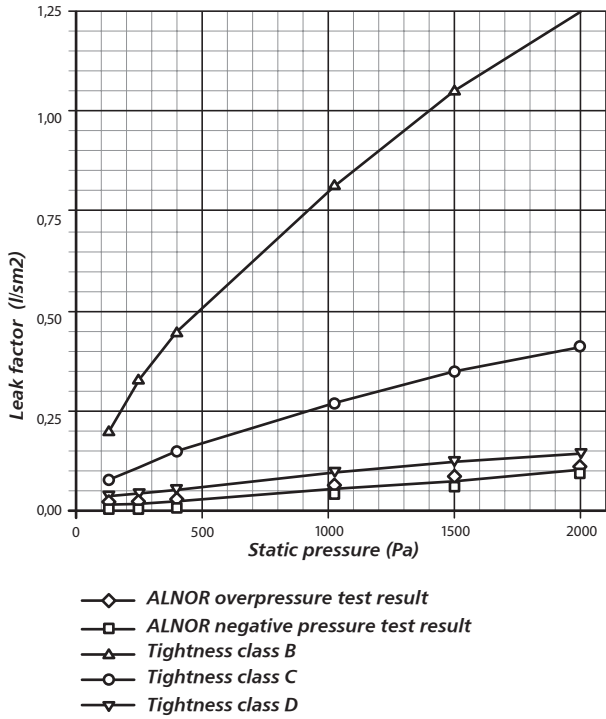

CREPDM cellular sponge gasket is resistant to weathering and UV radiation – therefore suitable for outdoor usage. During outdoor installation rain water accumulation areas should be avoided. Temperature range: -30°C to +120°C. A self-adhesive cut-out template included.

Minimal opening dimensions regarding duct size according to PN-EN 12907:

Oval or rectangular opening	
Width S of duct's side on which access door is mounted (mm)	Minimum dimensions for openings in ducts' walls (mm) AxB
$S \leq 200$	300x100
$200 \leq S < 500$	400x200
$500 < S$	500x400

