

INSTALLATION AND OPERATING INSTRUCTIONS

SIEGENIA[®]
brings spaces to life

AERO

AEROPLUS

Wall-mounted ventilator with heat recovery
and automatic air dehumidification.

Window systems

Door systems

Comfort systems

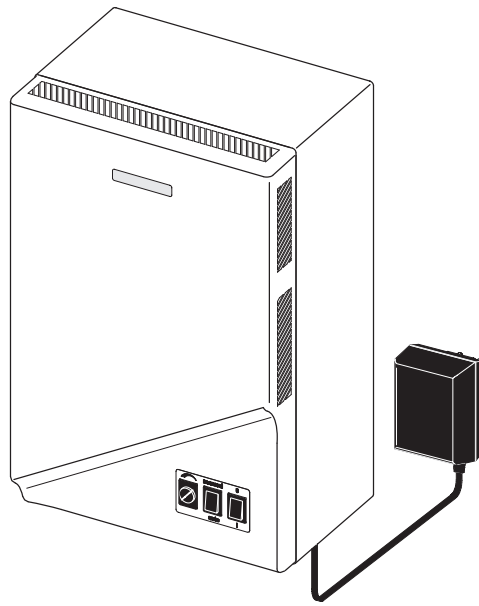

Contents

Target group of this documentation 3

Correct use 3

Safety notices 4

Scope of delivery 4

Function 5

Assembly 6

Operation 10

Care and maintenance 11

Technical specifications 13

Dimensions 14

Accessories 14

Liability 15

Feedback on documentation 15

Target group of this documentation

This documentation is intended for use by specialists only. All work described in this document is to be performed by experienced professionals with training and practice in the assembly, installation and maintenance of ventilation units. Safe and proper assembly of this unit is not possible without expert knowledge.







Correct use

- This unit is to be used exclusively for ventilating enclosed indoor spaces (kitchen, living room / bedroom, bathroom).
- Use the unit only with original accessories from SIEGENIA.
- The unit must always be installed by an experienced specialist, in accordance with the installation and planning documents of SIEGENIA. The installation instructions in this document must be complied with at all times.
- Do not install the unit in contaminated rooms and ensure that no hazardous substances can be drawn in.
- If the unit is to be used in a room with a heating unit that draws air from the room, prior authorisation must be obtained from the proper authorities, such as the officially appointed district chimney sweep.
- Use the unit only when it is in a technically sound condition.
- Do not modify the unit's components in any way.
- Ensure that the device's ventilation openings are kept free and are not blocked by other equipment, furniture or objects.
- Please do not put any objects on top of the unit.
- Do not use the device as a seat.
- Observe the safety regulations for operating electrical equipment and, if necessary, for ladders, steps and work overhead or at certain heights.
- Only operate and/or store the AEROPLUS at temperatures between -15 °C and +40 °C.
- Any use of this product that is not in accordance with its intended use, or any adaptation of or modification to the product and its associated components for which the express consent of SIEGENIA has not been obtained, is strictly prohibited. SIEGENIA accepts no liability whatsoever for any material losses or injury to people caused by failure to comply with this stipulation.
- The unit must be checked by a specialist in the event of a fault.

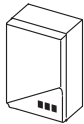
Safety notices

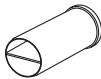
- This unit can be used by children aged 8 and above as well as by people with physical, sensory or mental difficulties or with a lack of experience and knowledge as long as they are supervised or have been instructed in how to use the unit safely and understand the resulting risks. Children must not play with the unit. Cleaning and user maintenance must not be carried out by children without supervision.
- Risk of fatal injury from electric shock or fire.
To prevent personal injury or damage to property, always comply with the following instructions:
 - The device may only be mounted in a protected area III in accordance with DIN VDE 0100. However, the device may also be mounted in a protected area II in accordance with DIN VDE 0100, if it is fixed with an additional screw in such a way that it cannot be removed from the wall without the use of tools. The mains socket for the unit must be in at least protection class III.
 - Only insert the Euro plug of the standard connecting cable into a suitable 230 V AC socket.
 - If the mains connection cable for the unit is damaged, it must be replaced by SIEGENIA, the company's customer service department, or similarly qualified personnel in order to prevent personal injury or damage to property.
 - Only a qualified electrician may perform any work on the 230 V AC mains power supply that is required in order to connect the unit.
 - All-pole safety isolation is required if the customer is fitting the mains cable.
 - Current local regulations (such as those of the VDE in Germany) must be observed.
 - Relevant country-specific regulations must be strictly followed for all work carried out on the voltage supply system or house wiring system.
 - Should a solid object or any liquid get inside the unit, stop operation immediately and disconnect the unit from the mains power supply.

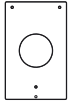
Scope of delivery

| | |
|---|---|
|  <p>AEROPLUS</p> |  <p>3 screws 3 dowels</p> |
|  <p>Pipe</p> |  <p>Adhesive tape (only for units with socket piece)</p> |
|  <p>weather grille</p> |  <p>Drilling template</p> |
| |  <p>Installation and operating instructions</p> |

Function

Features

- Simultaneous aeration and ventilation
- No formation of condensation in the unit
- Heat recovery
- Filters supply and exhaust air
- 12 V low voltage in the device
- Thermal overload protection in the transformer of the 230 V power supply
- Weather grille protects against direct snow- and rainfall

Ventilation operation

- The blower simultaneously conveys the exhaust air with one half section of the blower and the supply air with the other half section.
- The blower half sections are segregated so that the two air flows will not mix. The humidity of the air flows is balanced solely via a small bypass on the blower, meaning that no condensate can be formed inside the blower. The blower performance is continuously adjustable.
- The outside air (1) is drawn in through a filter (2) by means of the blower (3) and proceeds into the room as supply air (4).
- The exhaust air (5) is drawn in through a filter (2) by means of the blower (3) and makes its way outside as outgoing air (6).
- Both streams of air are drawn through the heat exchanger (7). Here, particularly during cold times of the year, the outside air is pre-heated by the warm exhaust air before it enters the room as supply air.

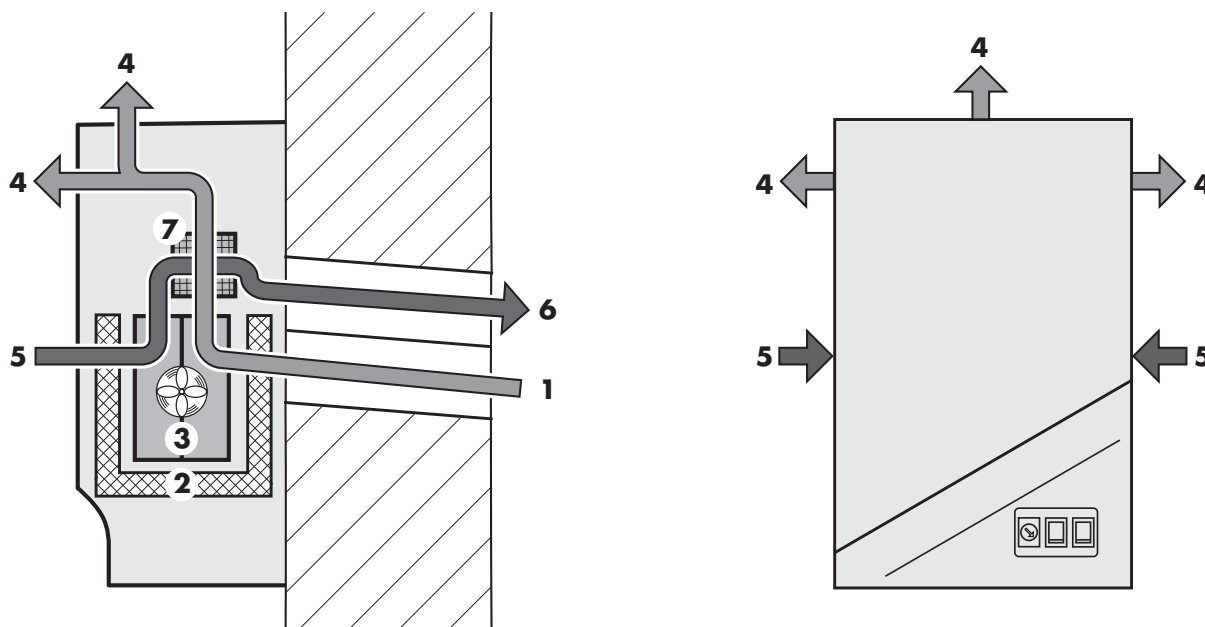

Assembly

- We would like to request you to contact your machine / tool supplier or SIEGENIA if you have any unanswered questions prior to the installation.
- The foundation of the installation site must be level (plastered) so that the device will be evenly seated.

⚠ WARNING Electrically operated unit.
Risk of fatal injury from electric shock or fire.

To prevent personal injury or damage to property, always comply with the following instructions.

- › Ensure that there are no supply lines (pipes or electrical cables) located at the site of the wall breakthrough and the mounting holes.
- › A weather grille is mounted on the wall or the pipe. Ensure when you select the operation location that you can mount the weather grille safely from the outside and secure the site of the wall breakthrough to the outside.

Recommended unit position

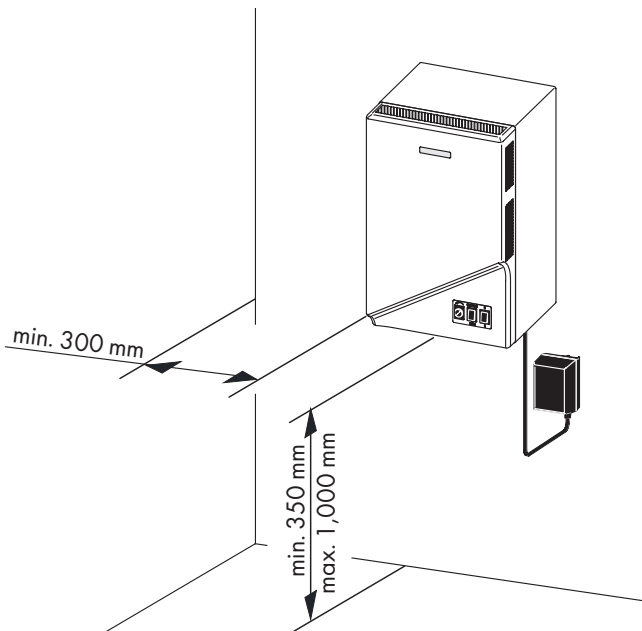

Assembly sequence

Step 1: Marking the holes and drilling the core hole

⚠ NOTICE Risk of damage to property by drilling through concealed cables or pipes!

- › Before installing the unit, use a suitable cable and pipe detector at the installation location to identify the presence of concealed cables or pipes in the wall (such as water pipes).

1. Use a water level to align the drilling template at a suitable position and attach to the wall.
2. Mark three mounting holes and the core mounting hole on the wall.

Note: You will only need the fourth (bottom) drilling hole marking of the drilling template if you mount the AEROPLUS in protection area II or a AEROPLUS with a socket piece.

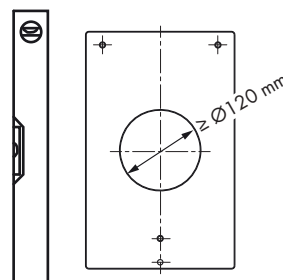

3. Drill core hole (≥ Ø 120 mm). Using a hammer drill at an angle of approx. 2° to 5°, drill a hole through to the outside wall.

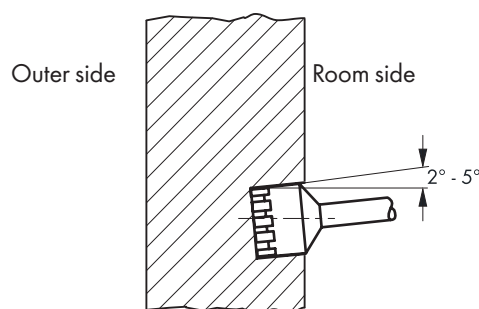

Step 2: Drilling the mounting holes and inserting the dowels

1. Drill the three marked mounting holes and, if required, the fourth mounting hole (all drilled holes should have a diameter of 8 mm and be at least 45 mm deep).
2. Insert dowels (included in delivery) into the drilled holes.

Note: depending on the type of wall (e.g. plaster-board), suitable dowels may need to be provided by the customer for inserting into the drill holes.

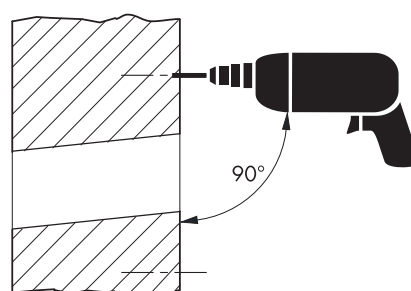

Step 3: Trim PVC ventilation pipe**Installation without socket piece**

1. Trim the pipe to wall thickness (dimension **X**).

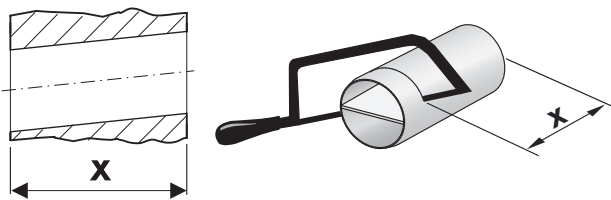
**Installation with socket piece (electrical closing flap)**

1. Trim the pipe to wall thickness (dimension **Y**) according to formula:
 $X = Y - 120 \text{ mm}$

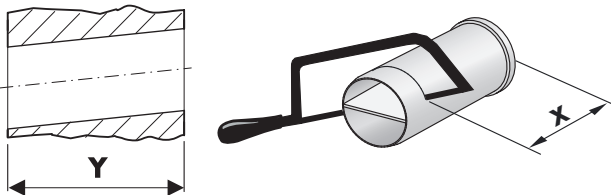
**Step 4:** Cable routing

1. Route the connection cable on the left or right side in the cable duct.
2. Establish a notch at the top of bottom edge of the cable duct with a suitable tool to guide the cable out of the device.

Note: The cable must be neatly routed in the cable duct to prevent it from being pushed through or squeezed during the installation.

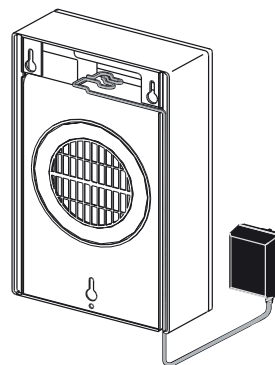
**Step 5 (only for installation with socket piece):** Fix pipe to socket piece

1. Push the side of the pipe with the recessed middle bar on to the socket piece of the ventilation unit until the pipe is firmly seated.
2. Fix the transition point with the adhesive tape included in the delivery. The pipe and socket pieces must be firmly interconnected.

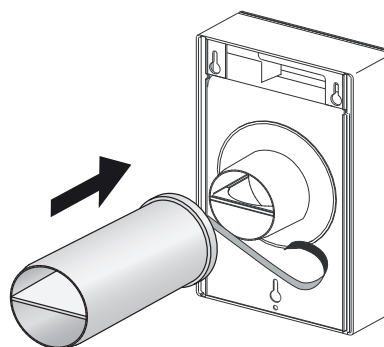

Step 6 : AEROPLUS fixing

Installation without socket piece

1. Screw three screws up to 8 mm in the dowels.

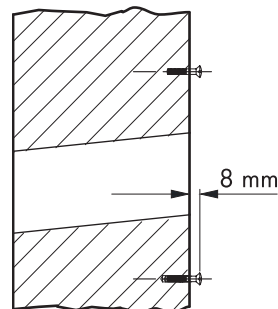

2. Push the ventilation pipe into the core boring (so that both ends are flush with the wall).
Note: The middle bar must be positioned horizontally.
3. Seal joints between pipe and wall breakthrough with permanently elastic sealing compound.
4. Guide the mounting openings on the rear of the unit over the fixing screws and push the unit downwards.
5. Check the secure seating of the unit.

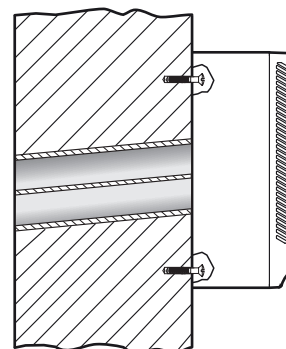

Additional security device for installation in protection area II

1. Remove the front panel and filter from the device (see page 10)
2. AEROPLUS Mount to the wall through the intended opening in the rear wall of the housing with a screw.
3. Fit the filter an front panel (see page 10)

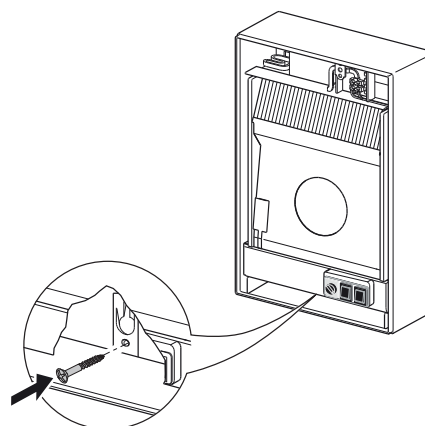

Installation with socket piece (electrical closing flap)

1. Lift the ventilation unit and push the pipe fixed to the unit through the wall opening.
2. Press the ventilation unit firmly against the wall and fix with three screws.
3. Check the secure seating of the unit.

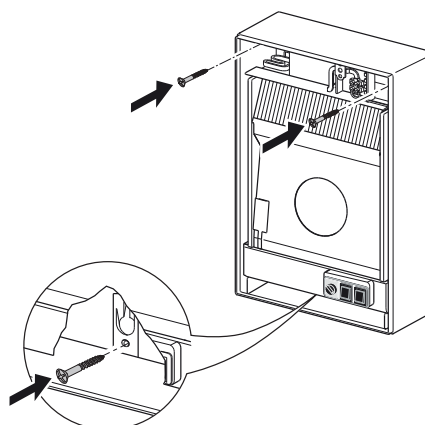

Step 7: Mounting the weather grille

1. Apply the permanent elastic sealing compound to the outer edge of the pipe and weather grille.
2. Press the weather grille firmly against the wall. Two clamps must be located above the middle bar and one clamp below the middle bar.

Notes:

- Ensure that the fins of the weather grille are pointing downwards.
- There must not be a gap at the transition from the pipe to the house wall.

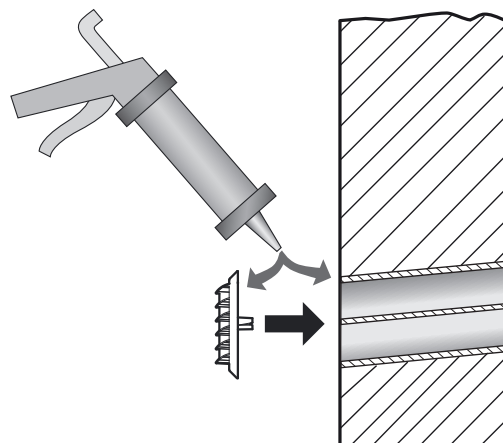

Step 8: Commissioning

1. Insert the power pack connector into a suitable 230-V AC mains power supply.
2. The device is now ready for operation.

Operation

| Operating function | Operating element | Comments |
|---|-------------------|---|
| Switching on I | | The blower switches on directly (manual) or the device is ready for operation (auto) |
| Switching off O | | Device off (blower off) |
| Manual mode of operation manual | | |
| Automatic mode of operation auto | | The device continuously checks the relative room air humidity and the outside temperature. In case of high air humidity, the blower switches on automatically if the outside air humidity is lower due to cool weather conditions. |
| Increasing the air throughput | | The air throughput is continuously variable during the blower operation |
| Reducing the air throughput | | |

Care and maintenance

⚠ WARNING**Electrically operated unit.****Risk of fatal injury from electric shock or fire.****To prevent personal injury or damage to property, always comply with the following instructions:**

- › Pull the mains plug out of the socket prior to every cleaning process or maintenance work. Never pull at the cable to disconnect the device from the electricity grid.
 - › For all devices with a permanent connection to the 230 V AC mains power supply, switch off all poles of the feeder. The fuses may need to be removed.
-

Cleaning

Important: When cleaning the AEROPLUS, do not allow liquids to get inside the unit.

- Never use cleaning agents that are aggressive or contain solvents, or sharp-edged objects, as these may damage the surfaces of the casing.
- Never clean the unit with a high-pressure cleaner or steam-jet cleaner.
- Clean the AEROPLUS with a cloth moistened with a mild soap solution or cleaning agent.

Replacing the filter

- Under normal conditions, the filter must be replaced at least every six months or when the air throughput starts to diminish.
- To exchange the filter, you must open the device according to the following instructions. Activate and remove only the specified device components.
- Only use genuine filters from SIEGENIA. You can purchase replacement filters from SIEGENIA or from specialist retailers.

1. Using a screwdriver, press lightly on the four clip points positioned at the sides of the front panel and pull the panel a little during the process.

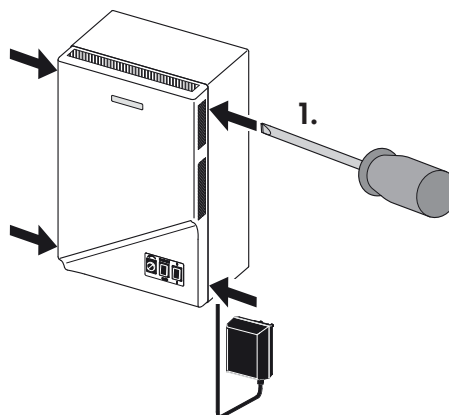

2. Carefully lift the front panel from the device and place it at the side.
3. Carefully draw the filter upwards and then forwards out of the device.
Note: The interior filter is held in place at the top by three barbs.
4. Dispose of the old filter in an environmentally safe manner.
5. On requirement, clean the freely accessible parts carefully with a dry cloth or an extremely soft brush. Do not use water and cleaning agents.

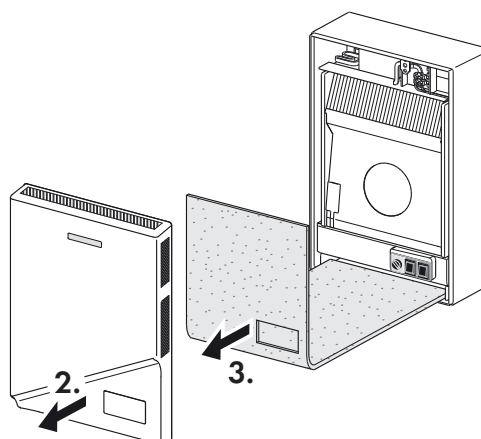

6. Insert the new filter into the device.
Note: The opening in the filter must be pushed over the control elements. Ensure that, as seen from the opening, the longer end of the filter is pushed into the device.
Attention! In order to obtain accurate measurement results, You must ensure that the humidity sensor (**a**) is seated over the filter.
7. Position the front panel on the front of the housing and press the panel with both hands until the four snap locks audibly engage.

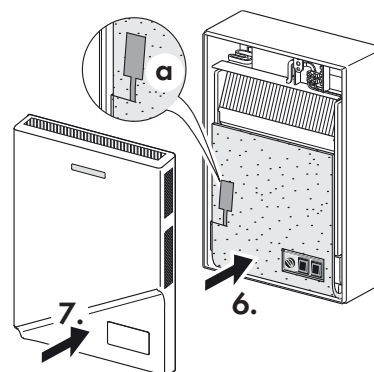

Technical specifications

| | AEROPLUS |
|--|---|
| Air throughput measured per air flow (measured based on DIN 24163) | of approx. 10 m ³ /h to approx. 30 m ³ /h |
| Inherent noise (measured in accordance with DIN EN ISO 3745, at 8 dB room insulation) | of L _N = 30 dB (A) to L _N = 40 dB (A) |
| Power consumption | of 4 W to 7 W |
| Electrical connection (power pack corrector 12 V with Euro plug) | 230 V~ / 0,03 A |
| Protection class | II |
| Connection cable (cable outlet at rear of unit, top) | 2 m long |
| Heat recovery efficiency | to 68 % |
| Sound absorption (measured according to DIN EN 20140-10) | R _{w1,9} = 33 dB D _{n,e,w} = 40 dB |
| Casing colour | RAL 9003 signal white |
| Bypass for the prevention of condensation in the device | |

Product data sheet (according to EU Regulation 1254/2014)

| | | |
|---|--|---|
| a | Manufacturer | SIEGENIA |
| b | Model identification | AEROPLUS |
| c | Energy consumption (SEV); Energy efficiency class (SEV class) (according to climatic zone warm / average / cold) | – 13,7 kWh/(m ² · a); E – 36,6 kWh/(m ² · a); A – 76,5 kWh/(m ² · a); A+ |
| d | Type | WLA / ELA |
| e | Type of drive | Rotational speed control |
| f | Heat recovery system | Recuperative |
| g | Degree of temperature change | 68 % |
| h | Highest air flow rate | 20 m ³ /h |
| i | Electrical input power | 7 W |
| j | Noise level | 46 dB (A) |
| k | Relative air flow rate | 14 m ³ /h |
| l | Relative pressure differential | – |
| m | Specific input power | 0,32 W/(m ³ /h) |
| n | Control factor / control typology | 1,21 / 0,65 |
| o | Highest degree of inner and outer leakage rate (inner / outer leakage) | 33 % / 91 % |
| p | Mixed rate (inner area / outer area) | 37 % / 8 % |
| q | Instructions for replacing filter | Replacing the filter see page 12 |
| r | Instructions for the mounting of outside air / exhaust air grilles (for one-directional ventilation units) | Mounting the weather grille see page 10 |
| s | Instructions for dismantling | – |
| t | Pressure fluctuation sensitivity of the air flow (at +20 Pa and -20 Pa) | 93 % |
| u | Air tightness between inside and outside | – |
| v | Annual power consumption | 2,3 kWh/a |
| w | Annual saving of heating energy (according to climatic zone warm / average / cold) | 18,9 kWh/a 41,7 kWh/a 81,6 kWh/a |

Dimensions

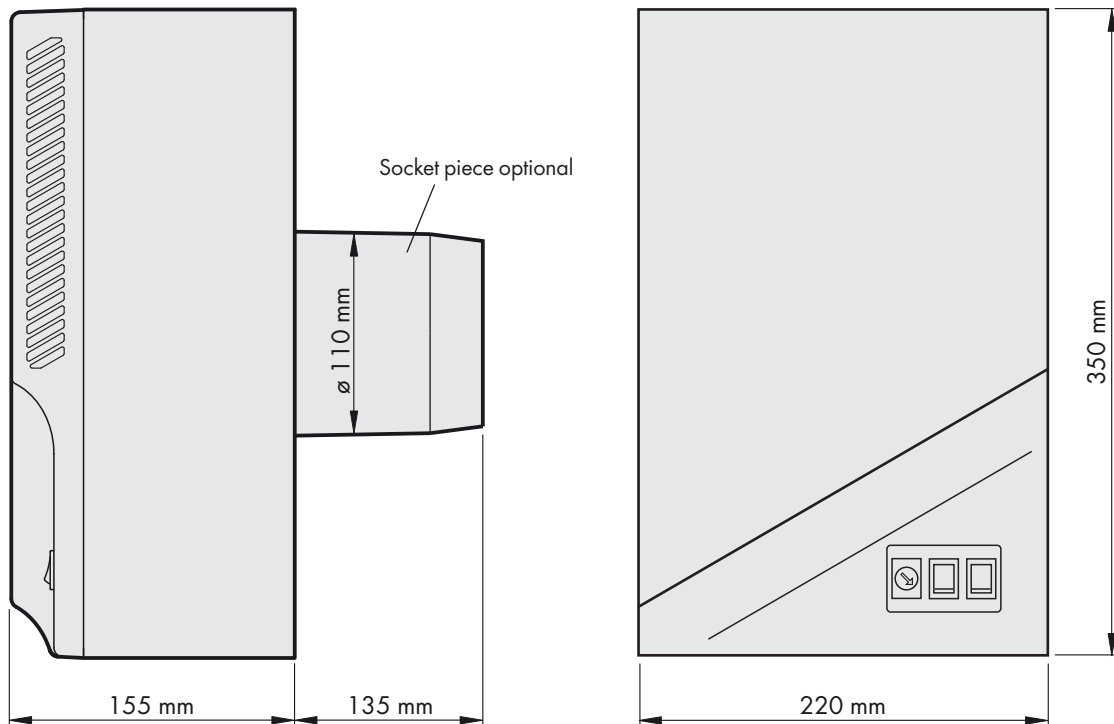

Accessories

| Material description | Material number |
|--|-----------------|
| Replacement filter | 895559 |
| PP ventilation pipe (2-way), 380 mm long | L3170010-096010 |
| PP ventilation pipe (2-way), 765 mm long | L3170020-096010 |
| PVC ventilation pipe (2-way), NW 100, 775 mm long (just for devices with socket piece) | L5300010-096010 |

Liability

Intended use

Any use of this product that is not in accordance with its intended use, or any adaptation of or modification to the product and its associated components for which our express consent has not been obtained, is strictly prohibited. We accept no liability whatsoever for any material losses or injury to people caused by failure to comply with this stipulation.

Product liability

Our products are guaranteed – subject to correct installation and proper use – for a period of one year from the date of receipt by a company (according to our general terms and conditions) or as otherwise agreed, and for a period of two years for end consumers, in accordance with statutory provisions. As part of our ongoing improvements, we reserve the right to replace individual components or entire products. Consequential losses resulting from defects are excluded from the warranty within the limits of the law. The warranty shall become void if modifications that are not authorised by us or have not been described in this documentation are performed on the product and/or individual components, or if the product and/or individual components is/are dismantled or partly dismantled, and the defect is due to the changes made.

Disclaimer of liability

The product and its components are subject to stringent quality controls. As a result, they function reliably and safely when used correctly. Our liability for consequential losses and/or claims for damages is excluded, except in the case of wilful misconduct or gross negligence, or where we are responsible for injury to life, physical injury or damage to health. Strict liability under the German Product Liability Act (Produkthaftungsgesetz) remains unaffected. Liability for the culpable violation of significant contractual obligations also remains unaffected; liability in this case is limited to losses that are specific to the contract and that could have been foreseen. The above regulations do not imply a change in the burden of proof to the detriment of the consumer.

EU Declaration of Conformity

 We, SIEGENIA-AUBI KG, declare under our own responsibility that the product complies with the provisions of Directives 2008/108/EC and 2006/95/EC of the Council of the European Union.

Environmental protection

Although our products do not fall within the scope of the German Electrical and Electronic Equipment Act, SIEGENIA will continue to meet the requirements of this Act and will endeavour to completely eliminate the use of substances that are hazardous to the environment as soon as this becomes technically feasible. Electrical products should not be disposed of as household waste.

Feedback on documentation

We welcome your comments and suggestions on how to improve our documentation. Please email your comments to documentation@siegenia.com.

SIEGENIA®

brings spaces to life

Head Office:
Industriestraße 1-3
57234 Wilnsdorf
GERMANY

Phone: +49 271 3931-0
Telefax: +49 271 3931-333
info@siegenia.com
www.siegenia.com



You can find address details for our
international sites at: www.siegenia.com

SIEGENIA worldwide:

Austria Phone: +43 6225 8301
Belarus Phone: +375 17 3143988
Benelux Phone: +31 85 4861080
China Phone: +86 316 5998198
France Phone: +33 3 89618131
Germany Phone: +49 271 39310
Great Britain Phone: +44 2476 622000

Hungary Phone: +36 76 500810
Italy Phone: +39 02 9353601
Poland Phone: +48 77 4477700
Russia Phone: +7 495 7211762
South Korea Phone: +82 31 7985590
Switzerland Phone: +41 33 3461010
Turkey Phone: +90 216 5934151
Ukraine Phone: +380 44 4637979

Contact your dealer: